

MarCal 16 ER

Digital Caliper



FUNCTIONS

- ON/OFF
- AUTO-ON / OFF
- RESET (set display to zero)
- mm/inch
- LOCK function (key lock)
- DATA (data transmission via connection cable)



FEATURES

- High contrast analog display
- Locking screw above
- Lapped guideway
- Measuring blade for inside measurements
- Slide and beam made of hardened stainless steel
- Step measuring function
- Immediate measurements due to the Reference System
- Raised guideway for the protection of the scale
- Dirt wipers are integrated in the slide
- SoftwareMarCom Professional free download: www.mahr.com/marcom (only for Mahr data cables and wireless systems with USB and RS232 interface)
- **Digit height:** 8.5 mm
- **Data interface:** USB, Opto RS232C, Digimatic
- **Energy supply:** Battery life approx. 3 years
- **IP protection category:** None
- **Package contains:** instruction manual, battery, case

TECHNICAL DATA

Order no.	Type	Measuring range		Numerical increment	Error limit		Standard	Depth rod	Friction wheel
		mm	inch		mm	inches (text)			
4103014	16 ER	0-150	0-6"	0.01 / .0005"	0.03	.001"	DIN 862	round	
4103015	16 ER	0-150	0-6"	0.01 / .0005"	0.03	.001"	DIN 862	round	•
4103016	16 ER	0-150	0-6"	0.01 / .0005"	0.03	.001"	DIN 862	rectangular	
4103017	16 ER	0-150	0-6"	0.01 / .0005"	0.03	.001"	DIN 862	rectangular	•
4103018	16 ER	0-200	0-8"	0.01 / .0005"	0.03	.001"	DIN 862	rectangular	
4103019	16 ER	0-200	0-8"	0.01 / .0005"	0.03	.001"	DIN 862	rectangular	•
4103020	16 ER	0-300	0-12"	0.01 / .0005"	0.04	.0015"	Factory standard		
4103021	16 ER	0-300	0-12"	0.01 / .0005"	0.04	.0015"	Factory standard		•

Order no.	a	b	c	d	e
	mm	mm	mm	mm	mm
4103014	10	40	16	235	16
4103015	10	40	16	235	16
4103016	10	40	16	235	16
4103017	10	40	16	235	16
4103018	10	50	19	285	16
4103019	10	50	19	285	16
4103020	14	64	19	388	16
4103021	14	64	19	388	16

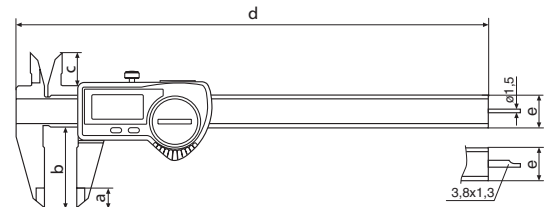

ACCESSORIES

Order no.	Product name	Type
4102020	Depth bridge (75 x 7 mm)	16 Em
4102357	16 EXu data connection cable USB (2 m)	16 EXu
4102410	Data connection cable RS232C (2 m)	16 EXr
4102520	Battery 3 V, CR 2032	
4102915	Digimatic data cable (2 m)	16 EWd

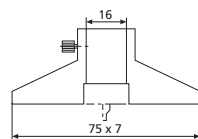

16 Em