

### FEATURES

With long stylus, for measurements at poorly accessible measuring points

- High-contrast dial face, sealed with O-ring
- Mineral glass viewing panel for best protection:
  - against cracking, scratching or damage caused by hot shavings
  - optimum resistance to solvents
- Matt chrome-plated protective casing with three integrated dovetail guide rails
- Shockproof measuring mechanism
- Anti-magnetic model
- Automatic adjustment to the contacting direction ensuring infallible readings
- Ball bearing mounted double lever
- Friction clutch overload protection
- **Package contains:** case, instruction manual, spanner for changing the styli, stylus dia.  $\varnothing$  2 mm, mounting shaft 800a6 (800 SA/SGA/SGB), mounting shaft 800a8



### Application:

- Measurement of concentricity, alignment, parallelism and flatness
- Centering of bores and shafts
- Parallel or perpendicular alignment of work pieces

### TECHNICAL DATA

Order no.		4301300	4306200	4306250
Product type		800 SGB	800 SL	800 SGL
Measuring range	mm	$\pm 0.5$	$\pm 0.25$	
Graduation value	mm	0.01		
Measuring surface		carbide		
Scale diameter	mm	38	28	38
Type of dial face		50–0–50	25–0–25	
Dial color		Yellow		
Measuring force	N	0.07		
Range per rev.	mm	1	0.5	
Deviation range $f_e$	$\mu\text{m}$	10		
Total deviation range $f_{ges}$	$\mu\text{m}$	13		
Hysteresis $f_u$	$\mu\text{m}$	4	5	
Partial measuring span $f_t$	$\mu\text{m}$	5		
Repeatability $f_w$	$\mu\text{m}$	3		
Standard		Factory standard		

Order no.	a	b	c	d	e	f	Measuring anvil length
	mm	mm	mm	mm	mm	mm	mm
4301300	40.5		31.4	35.7	93	117	32.3
4306200		30	40.3	44.6	102	126	41.24
4306250	40.5		40.3	44.6	102	126	41.24

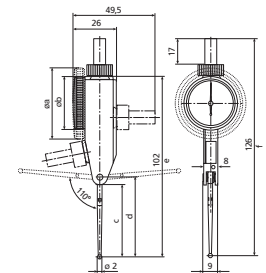

### ACCESSORIES

Order no.	Product name	Product type
4301851	Stylus $\varnothing$ 1.0 mm, carbide, $l = 32.3$ mm	800 tb
4301850	Stylus $\varnothing$ 2.0 mm, carbide, $l = 32.3$ mm	800 tb
4301852	Stylus $\varnothing$ 3.0 mm, carbide, $l = 32.3$ mm	800 tb
4309052	Stylus $\varnothing$ 2.0 mm, ruby, $l = 32.3$ mm	800 tbr
4305868	Spanner	
4306851	Stylus $\varnothing$ 1.0 mm, carbide, $l = 41.24$ mm	800 tl
4306850	Stylus $\varnothing$ 2.0 mm, carbide, $l = 41.24$ mm	800 tl
4306853	Stylus $\varnothing$ 3.0 mm, carbide, $l = 41.24$ mm	800 tl
4309053	Stylus $\varnothing$ 2.0 mm, ruby, $l = 41.24$ mm	800 tlr

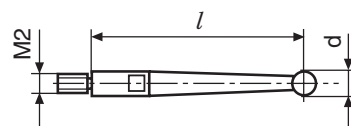

800 tb;800 tbr;800 te;800 ter;800 tl;800 tlr;800 ts;800 tsr;801 tl